

PLAN VIEW
1:500

- THE FOLLOWING DOORS ARE AVAILABLE AT EXTRA CHARGE:
- SINGLE PERSONNEL DOOR 1219w x 2134h (C/W 3048 HOOD)
 - DOUBLE PERSONNEL DOOR 1830w x 2134h (C/W 3048 HOOD)
 - SIDE SLIDING CARGO DOOR 4369w x 4420h
 - END SLIDING CARGO DOOR TOP 5000w, BASE 5230w x 4420h
 - DOUBLE PANEL ROLLING DOOR TOP 1930w, BASE 10590w x 13810h ((SEE DPRD-45.7m (150'))
 - TRIPLE PANEL ROLLING DOOR TOP 2896w, BASE 15800w x 13810h ((SEE TPRD-45.7m (150'))

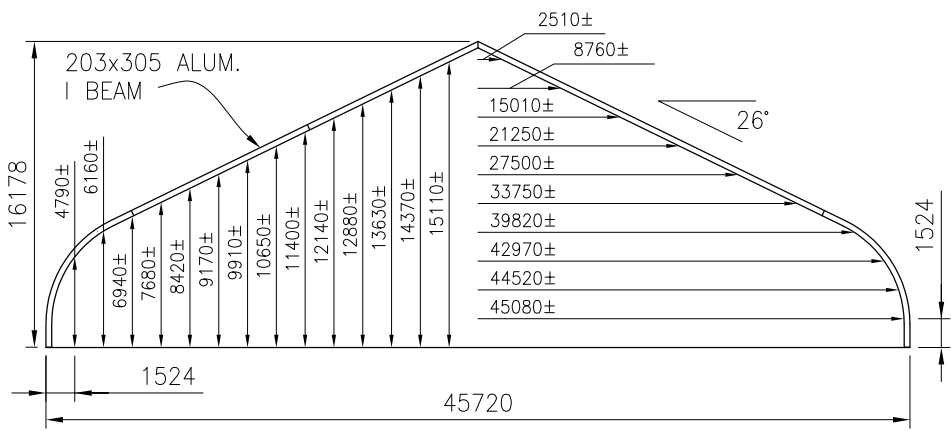

SECTION 45.7m STRUCTURE
1:400

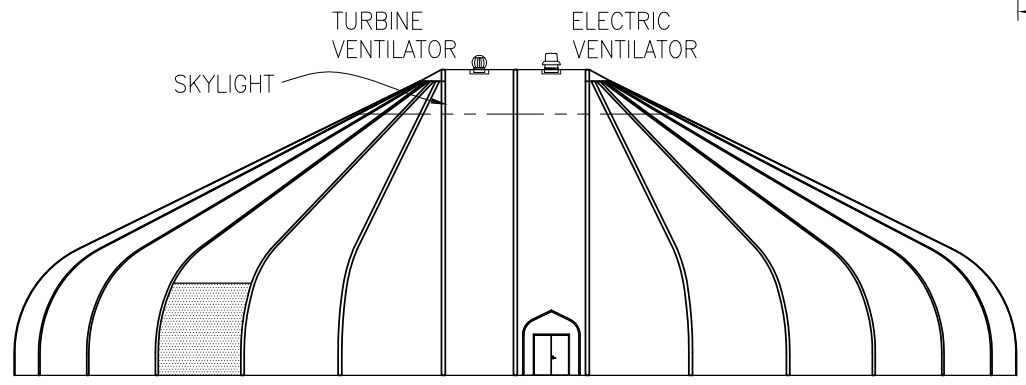

ELEVATION
1:400

SIGNATURE SERIES

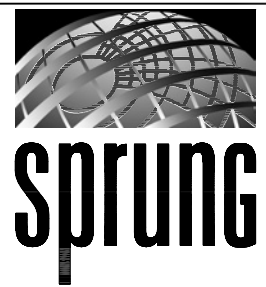

SIGNATURE SERIES 45.7m WIDE STRUCTURE	
DATE 08/25/2006	SCALE AS NOTED
DRAWING # S-150 METRIC	