

PLAN VIEW
1:500

3048w HOOD (102x76) C/W
DOUBLE PERSONNEL DOOR

- THE FOLLOWING DOORS ARE AVAILABLE AT EXTRA CHARGE:
- SINGLE PERSONNEL DOOR 1219w x 2134h (C/W 3048 HOOD)
 - DOUBLE PERSONNEL DOOR 1830w x 2134h (C/W 3048 HOOD)
 - SIDE SLIDING CARGO DOOR 4369w x 4420h
 - END SLIDING CARGO DOOR TOP 5020w, BASE 5280w x 4420h
 - DOUBLE PANEL ROLLING DOOR TOP 5280w,
BASE 10660w x 13050h ((SEE DPRD-42.7m (140'))
 - TRIPLE PANEL ROLLING DOOR TOP 3120w,
BASE 15900w x 13050h ((SEE TPRD-42.7m (140'))

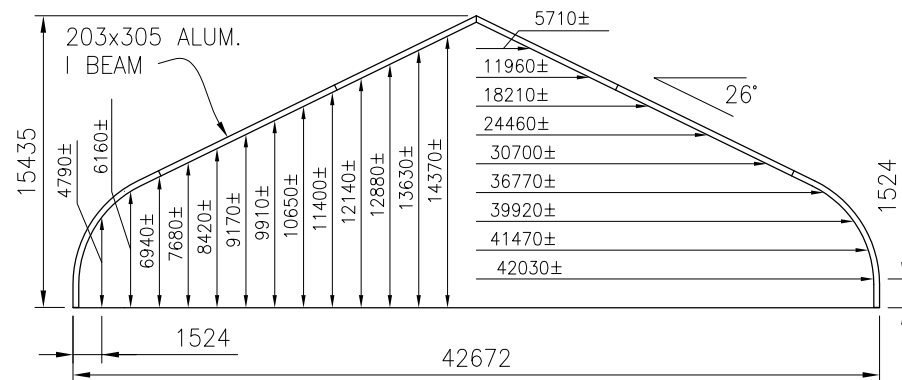

SECTION 42.7m STRUCTURE
1:400

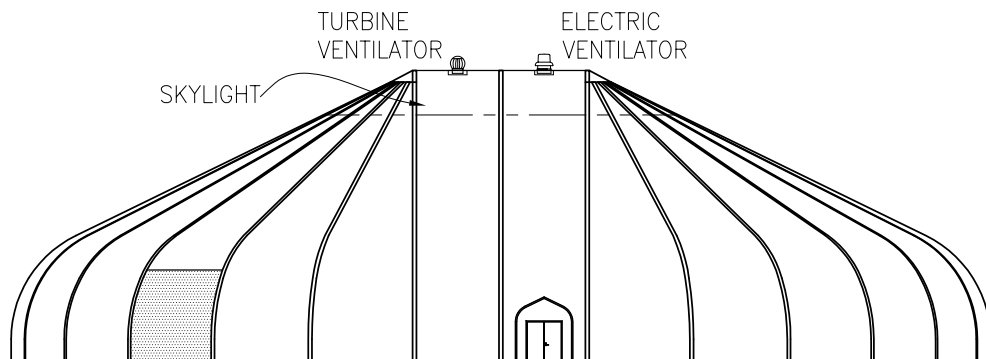

ELEVATION
1:400

SIGNATURE SERIES

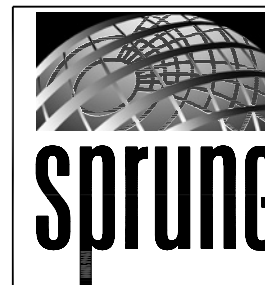

SIGNATURE SERIES
42.7m WIDE
STRUCTURE

DATE
08/25/2006

SCALE
AS NOTED

DRAWING #

S-140 METRIC