

PLAN VIEW
1:400

- THE FOLLOWING DOORS ARE AVAILABLE AT EXTRA CHARGE:
- SINGLE PERSONNEL DOOR 1219w x 2134h (C/W 3048 HOOD)
 - DOUBLE PERSONNEL DOOR 1830w x 2134h (C/W 3048 HOOD)
 - SIDE SLIDING CARGO DOOR 4360w x 4420h
 - END SLIDING CARGO DOOR TOP 5100w, BASE 5410w x 4420h
 - DOUBLE PANEL ROLLING DOOR TOP 1700w, BASE 10900w x 12210h ((SEE DPRD-36.6m (120'))
 - TRIPLE PANEL ROLLING DOOR TOP 2510w, BASE 16120w x 12210h ((SEE TPRD-36.6m (120'))

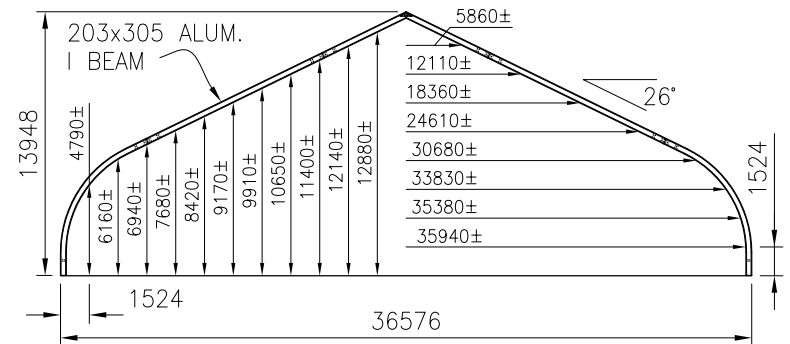

SECTION 36.6m STRUCTURE
1:400

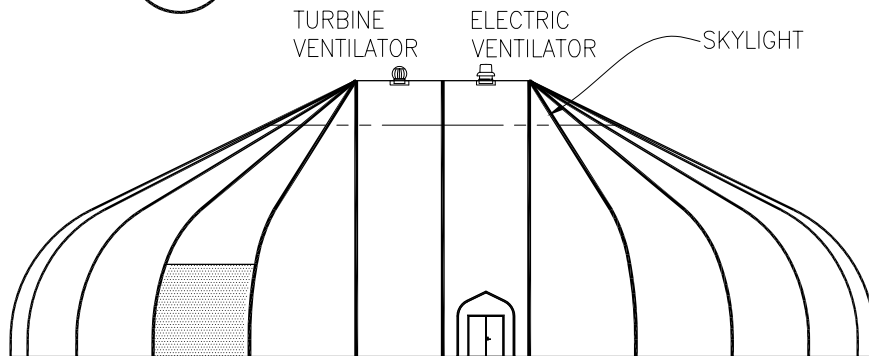

ELEVATION
1:400

SIGNATURE SERIES

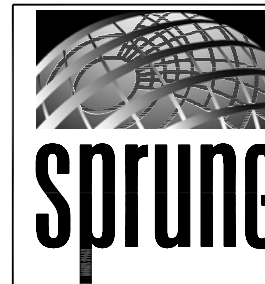

SIGNATURE SERIES
36.6m WIDE
STRUCTURE

DATE
08/25/2006

SCALE
AS NOTED

DRAWING #

S-120 METRIC