

○ PLAN VIEW
1:400

- THE FOLLOWING DOORS ARE AVAILABLE AT EXTRA CHARGE:
- SINGLE PERSONNEL DOOR 1219w x 2134h (C/W 3048 HOOD)
 - DOUBLE PERSONNEL DOOR 1830w x 2134h (C/W 3048 HOOD)
 - SIDE SLIDING CARGO DOOR 4360w x 4420h
 - END SLIDING CARGO DOOR TOP 5150w, BASE 5510w x 4420h
 - DOUBLE PANEL ROLLING DOOR TOP 1880w, BASE 11050w x 11480h ((SEE DPRD-33.5m (110'))
 - TRIPLE PANEL ROLLING DOOR TOP 2760w, BASE 16280w x 11480h ((SEE TPRD-33.5m (110'))

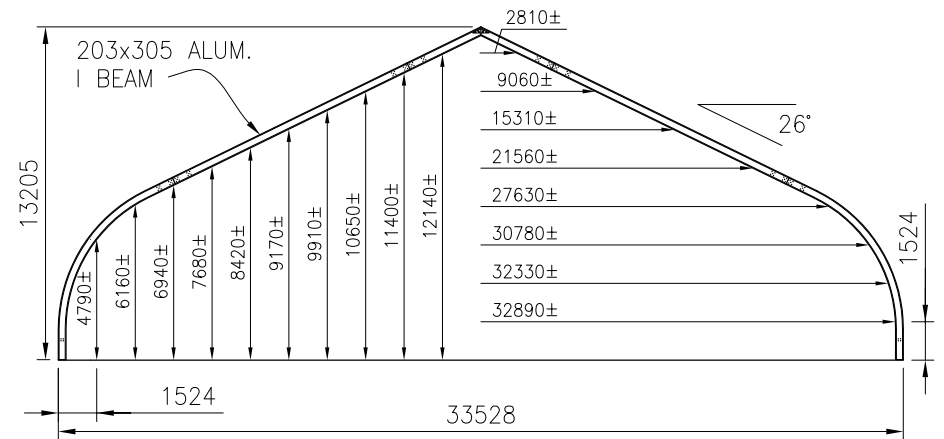

○ SECTION 33.5m STRUCTURE
1:300

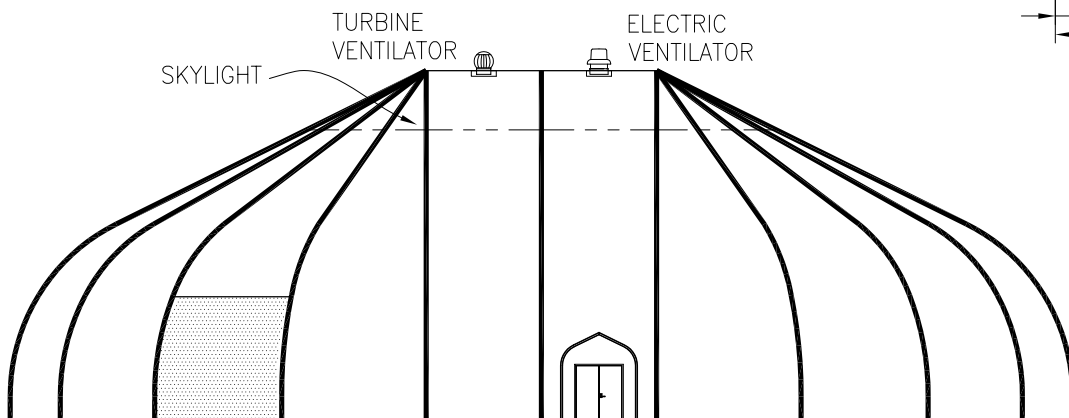

○ ELEVATION
1:300

SIGNATURE SERIES

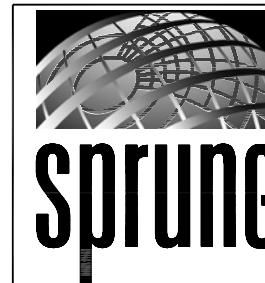

SIGNATURE SERIES
33.5m WIDE
STRUCTURE

DATE
08/25/2006

SCALE
AS NOTED

DRAWING #

S-110 METRIC