

PLAN VIEW
1:400

- THE FOLLOWING DOORS ARE AVAILABLE AT EXTRA CHARGE:
- SINGLE PERSONNEL DOOR 1219w x 2134h (C/W 3048 HOOD)
 - DOUBLE PERSONNEL DOOR 1830w x 2134h (C/W 3048 HOOD)
 - SIDE SLIDING CARGO DOOR 4360w x 4420h
 - END SLIDING CARGO DOOR TOP 5250w, BASE 5610w x 4420h
 - DOUBLE PANEL ROLLING DOOR TOP 3100w, BASE 11220w x 10080h ((SEE DPRD-30.5m (100'))
 - TRIPLE PANEL ROLLING DOOR TOP 4520w, BASE 16400w x 10080h ((SEE TPRD-30.5m (100'))

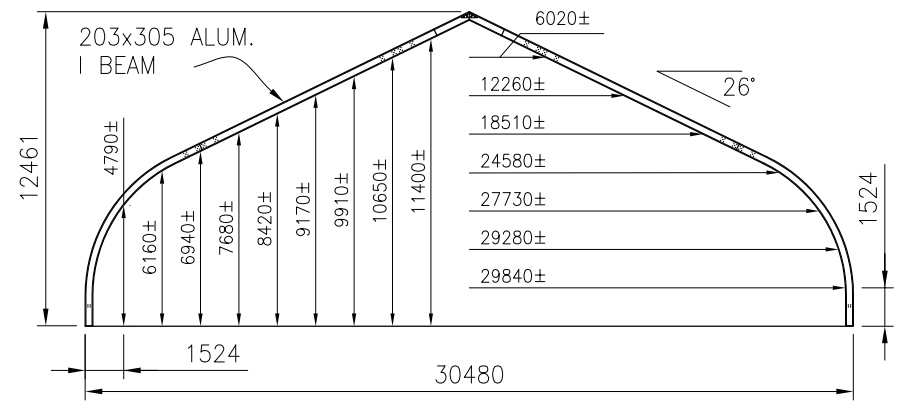

SECTION 30.5m STRUCTURE
1:300

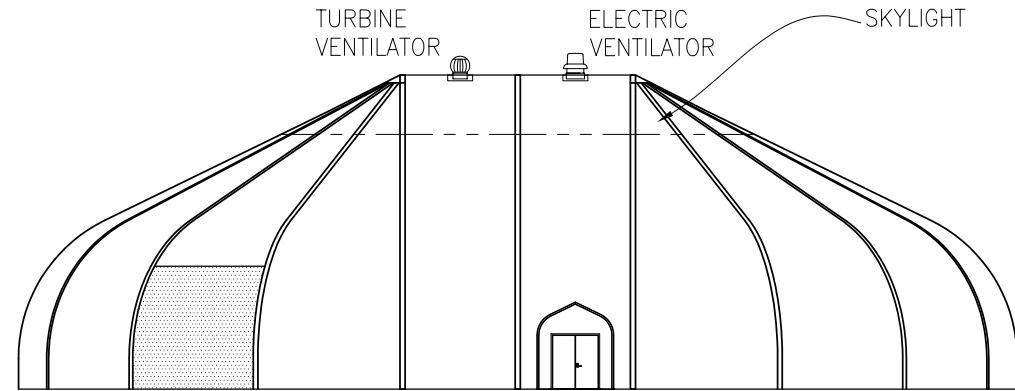

ELEVATION
1:300

SIGNATURE SERIES



SIGNATURE SERIES 30.5m WIDE STRUCTURE	
DATE 08/25/2006	SCALE AS NOTED
DRAWING # S-100 METRIC	